

DIVERSIFIED AIR SYSTEMS, INC.

MAXFLO™-PHV-EXP

Explosion Proof Portable High Vacuum System

- **Powerful explosion proof motor and vacuum pump, 120/1/60, Nominal 140 CFM**
- **Vacuum and collect explosive powders and dust safely**
- **Cyclonic prefiltration with secondary polyester cartridge filtration with final HEPA filter**



- **Explosion proof starter and junction box**
- **Heavy duty 14 gauge construction, powder coated paint**
- **Large 15 gallon collection canister**

Superior technology generating substantial operating savings

OUTSTANDING MAXFLO STANDARD FEATURES

SPECIFICATIONS

Voltage	Volts	120
Current Draw	Amps	12
Power	Watts	1300
Waterlift, max.	Inches H2O	70
Airflow, max	CFM	140
Collection Canister	Gallons	15
Filter Area	Sq. ft.	22
Weight, 30 gal. tank	Lbs.	103
Sound level @ 10'	dB(A)	78
HEPA filter efficiency	%	99.97% at 0.3 micron

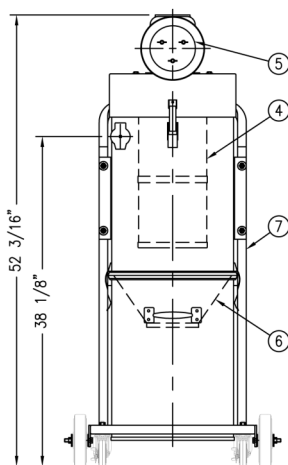
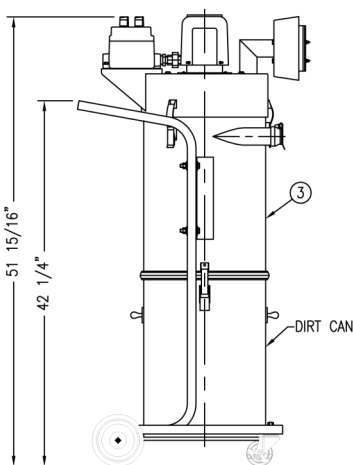
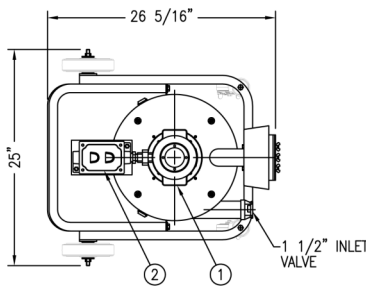

Note: Specifications listed above may be modified to suit application. contact D.A.S. or representative for information.

PRODUCT DESCRIPTION

The MAXFLO Explosion Proof portable vacuum safely collects explosive powders and dust.

- Powerful 110 volt, 12 amp, 1300 watt explosion proof motor and vacuum pump provide 140 CFM and 70" W.C. vacuum
- Explosion proof starter and junction box (customer to supply cord and plug)
- Unit is grounded to eliminate static build-up
- Excellent filtration - the tangential entry and the cyclonic cone remove 85% of the dust before it reaches the large 8" x 16" polyester cartridge filter (22 sq. ft. of filter media). Final HEPA filter (99.97% efficient to .3 microns).
- Large 15 gallon collection canister. A 5 gallon collection canister is available for aluminum applications.
- Mounted on a heavy duty welded tubular steel frame with a powder coat finish and with 4" poly rear wheels and 2" swivel (lockable) front wheels. Unit is available in Stainless Steel.
- MAXFLO offers a full range of anti-static conductive vacuum hoses, wands and cleaning tools.

CLASSIFICATIONS

Motor and fan are rated for Class I-Group D, and Class II - Groups E, F, & G hazardous locations.

- Class I, Group D - Atmospheres containing gasoline, petroleum, naphtha, benzene, butane, propane, alcohols, acetone, benzol, lacquer solvent vapors, or natural gas.
- Class II, Group E - Atmospheres containing metal dust, including magnesium, aluminum, and their commercial alloys
- Class II, Group F - Atmospheres containing carbon black, coal, or coke dust.
- Class II, Group G - Atmospheres containing flour, starch, or grain dusts.

Diversified Air Systems, Inc.

10801 Electron Drive, Louisville, Kentucky 40299

Toll free: **(800) 264-8958**

Tel.: **(502) 267-0333** • Fax: **(502) 267-4241**

Website: www.diversair.com • email: info@diversair.com